

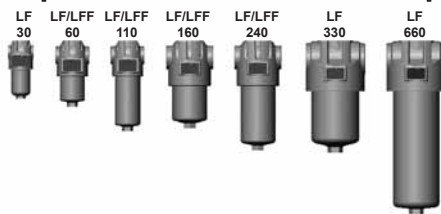

## Inline Filter LF Inline Filter LFF for Reversible Oil Flow up to 660 l/min, up to 100 bar



### 1. TECHNICAL SPECIFICATIONS

#### 1.1 FILTER HOUSING

##### Construction

The filter housings are designed in accordance with international regulations. They consist of a filter head and a screw-in filter bowl. LFF filters are suitable for flow in both directions.

Standard equipment:

- connection for a clogging indicator in filter head
- mounting holes in the filter head
- drain screw with pressure relief (LF 330 and above)

#### 1.2 FILTER ELEMENTS

HYDAC filter elements are validated and their quality is constantly monitored according to the following standards:

- ISO 2941
- ISO 2942
- ISO 2943
- ISO 3724
- ISO 3968
- ISO 11170
- ISO 16889

#### Contamination retention capacities in g

Betamicon® (BN4HC)				
LF/LFF	3 µm	5 µm	10 µm	20 µm
30	4.6	5.1	5.4	5.6
60	6.5	7.3	7.8	8.0
110	13.8	15.5	16.4	16.9
160	19.8	22.2	23.5	24.3
240	32.3	36.3	38.4	39.6
330	47.2	53.1	56.1	57.9
660	102.2	114.9	121.5	125.4

Betamicon® (BH4HC)				
LF/LFF	3 µm	5 µm	10 µm	20 µm
30	3.0	2.9	3.2	3.7
60	4.6	4.5	5.0	5.7
110	10.1	9.9	10.9	12.4
160	12.9	12.6	13.9	15.9
240	21.6	21.1	23.2	26.5
330	34.6	33.9	37.2	42.5
660	76.8	75.2	82.6	94.3

Filter elements are available with the following pressure stability values:

Betamicon® (BN4HC):	20 bar
Betamicon® (BH4HC):	210 bar
Wire mesh (W):	20 bar
Stainless steel fibre (V):	210 bar

### 1.3 FILTER SPECIFICATIONS

Nominal pressure	100 bar
Fatigue strength	At nominal pressure 10 <sup>6</sup> cycles from 0 to nominal pressure (For other pressures, see graph at 1.8)
Temperature range	-30 °C to +100 °C (LF/LFF 660: -30 °C to -10 °C: p <sub>max</sub> = 75 bar)
Material of filter head	Aluminium
Material of filter bowl	Aluminium
Type of clogging indicator	VM (differential pressure measurement up to 210 bar operating pressure)
Pressure setting of the clogging indicator	5 bar (others on request)
Bypass cracking pressure (optional)	6 bar (others on request)

### 1.4 SEALS

NBR (= Perbunan)

### 1.5 INSTALLATION

As inline filter with or without reversible oil flow

### 1.6 SPECIAL MODELS AND ACCESSORIES

- Bypass valve built into the head, separate from the main flow
- Oil drain screw up to LF/LFF 240
- Seals in FPM, EPDM
- Test and approval certificates

### 1.7 SPARE PARTS

See Original Spare Parts List

### 1.8 FATIGUE STRENGTH

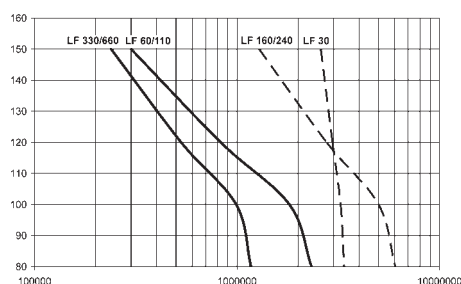

### 1.9 CERTIFICATES AND APPROVALS

On request

### 1.10 COMPATIBILITY WITH HYDRAULIC FLUIDS ISO 2943

- Hydraulic oils H to HLPD DIN 51524
- Lubrication oils DIN 51517, API, ACEA, DIN 51515, ISO 6743
- Compressor oils DIN 51506
- Biodegradable operating fluids VDMA 24568 HETG, HEES, HEPG
- Fire-resistant fluids HFA, HFB, HFC and HFD
- Operating fluids with high water content (>50% water content) on request

### 1.11 IMPORTANT INFORMATION

- Filter housings must be earthed.
- When using electrical clogging indicators, the electrical power supply to the system must be switched off before removing the clogging indicator connector.

### Symbol for hydraulic systems

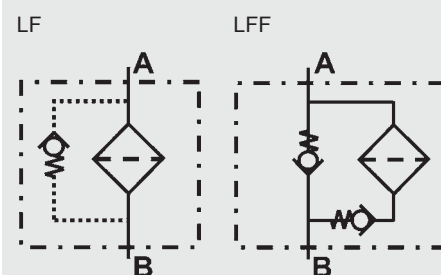

## 2. MODEL CODE (also order example)

**LF BN/HC 60 I C 10 D 1 . X /-L24**

### 2.1 COMPLETE FILTER

**Filter type** \_\_\_\_\_

LF or LFF

**Filter material of element** \_\_\_\_\_

BN/HC Betamicron® (BN4HC)  
 BH/HC Betamicron® (BH4HC)  
 W Stainless steel wire mesh  
 V Stainless steel fibre

**Size of filter or element** \_\_\_\_\_

LF: 30, 60, 110, 160, 240, 330, 660  
 LFF: 60, 110, 160, 240

**Operating pressure** \_\_\_\_\_

I = 100 bar

**Type and size of connection** \_\_\_\_\_

Type	Port	Filter size						
		30	60	110	160	240	330	660
B	G ½	●						
C	G ¾		●	●				
E	G1 ¼				●	●		
F	G1 ½						●	●

**Filtration rating in µm** \_\_\_\_\_

BN/HC, BH/HC, V: 3, 5, 10, 20  
 W: 25, 50, 100, 200

**Type of clogging indicator** \_\_\_\_\_

Y plastic blanking plug in indicator port  
 A steel blanking plug in indicator port  
 B visual  
 C electrical  
 D visual and electrical  
 for other clogging indicators, see brochure no. 7.050../..

**Type code** \_\_\_\_\_

1

**Modification number** \_\_\_\_\_

X the latest version is always supplied

**Supplementary details** \_\_\_\_\_

B. bypass cracking pressure (e.g. B6 = 6 bar); without details = without bypass valve  
 L... light with appropriate voltage (24V, 48V, 110V, 220V)  
 LED 2 light emitting diodes up to 24 Volt  
 SO184 pressure release/oil drain screw (standard for LF 330 and above)  
 V FPM seals  
 W suitable for HFA, HFC oil-water emulsions (only necessary when using a clogging indicator or V or W elements)

### 2.2 REPLACEMENT ELEMENT

**0060 D 010 BN4HC /-V**

**Size** \_\_\_\_\_

0030, 0060, 0110, 0160, 0240, 0330, 0660

**Type** \_\_\_\_\_

D

**Filtration rating in µm** \_\_\_\_\_

BN4HC, BH4HC, V: 003, 005, 010, 020  
 W: 025, 050, 100, 200

**Filter material** \_\_\_\_\_

BN4HC, BH4HC, V, W

**Supplementary details** \_\_\_\_\_

V, W (for descriptions, see point 2.1)

### 2.3 REPLACEMENT CLOGGING INDICATOR

**VM 5 D . X /-L24**

**Type of indicator** \_\_\_\_\_

VM differential pressure indicator up to 210 bar operational pressure

**Pressure setting** \_\_\_\_\_

5 standard for LF filters 5 bar  
 8 standard for LFF filters 8 bar  
 others on request

**Type of clogging indicator** \_\_\_\_\_

D (see Point 2.1)

**Modification number** \_\_\_\_\_

X the latest version is always supplied

**Supplementary details** \_\_\_\_\_

L..., LED, V, W (for descriptions, see point 2.1)

### 3. FILTER CALCULATION / SIZING

The total pressure drop of a filter at a certain flow rate Q is the sum of the housing  $\Delta p$  and the element  $\Delta p$  and is calculated as follows:

$$\Delta p_{\text{total}} = \Delta p_{\text{housing}} + \Delta p_{\text{element}}$$

$$\Delta p_{\text{housing}} = (\text{see Point 3.1})$$

$$\Delta p_{\text{element}} = Q \cdot \frac{SK^*}{1000} \cdot \frac{\text{viscosity}}{30}$$

(\*see Point 3.2)

For ease of calculation, our Filter Sizing Program is available on request free of charge.

**NEW:** Sizing online at [www.hydac.com](http://www.hydac.com)

#### 3.1 $\Delta p$ -Q HOUSING CURVES BASED ON ISO 3968

The housing curves apply to mineral oil with a density of 0.86 kg/dm<sup>3</sup> and a kinematic viscosity of 30 mm<sup>2</sup>/s. In this case, the differential pressure changes proportionally to the density.

##### LF 30

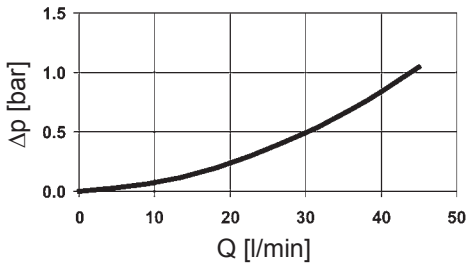

##### LF 60-110

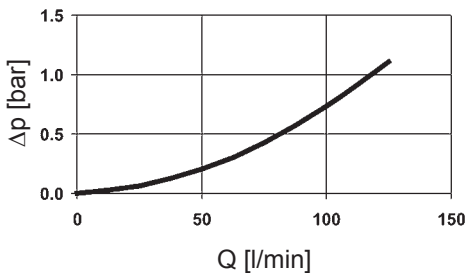

##### LF 160-240

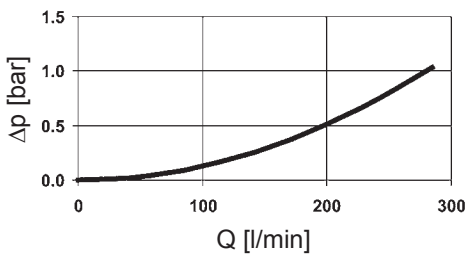

##### LF 330-660

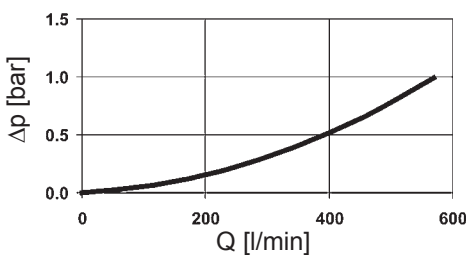

**LF  $\Delta p$ -Q housing curves on request!**

### 3.2 GRADIENT COEFFICIENTS (SK) FOR FILTER ELEMENTS

The gradient coefficients in mbar/(l/min) apply to mineral oils with a kinematic viscosity of 30 mm<sup>2</sup>/s. The pressure drop changes proportionally to the change in viscosity.

LF/	V				W	BH4HC			
	3 $\mu\text{m}$	5 $\mu\text{m}$	10 $\mu\text{m}$	20 $\mu\text{m}$		–	3 $\mu\text{m}$	5 $\mu\text{m}$	10 $\mu\text{m}$
30	18.0	13.0	7.4	3.7	3.367	91.2	50.7	36.3	19.0
60	16.0	11.0	6.5	3.3	1.683	58.6	32.6	18.1	12.2
110	8.3	6.0	4.2	2.1	0.918	25.4	14.9	8.9	5.6
160	4.5	3.2	2.3	1.4	0.631	16.8	10.4	5.9	4.4
240	3.2	2.4	1.9	1.1	0.421	10.6	6.8	3.9	2.9
330	2.1	1.5	1.3	0.8	0.307	7.7	4.5	2.8	2.0
660	1.1	0.9	0.6	0.3	0.153	3.3	1.9	1.0	0.9

#### BN4HC: 30

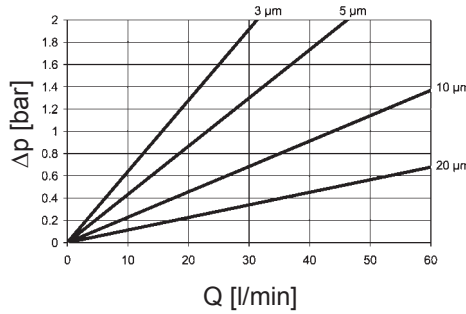

#### BN4HC: 60

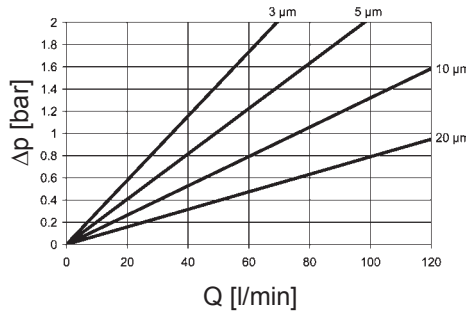

#### BN4HC: 110

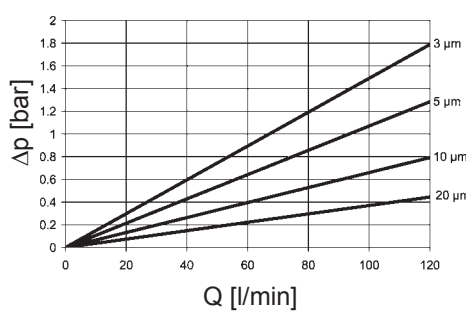

#### BN4HC: 160

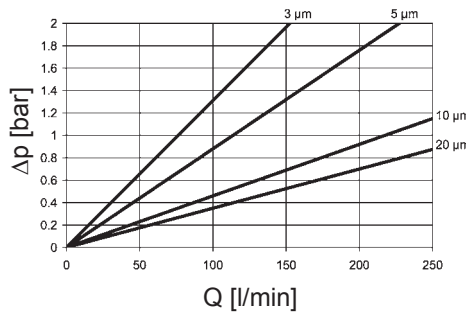

#### BN4HC: 240

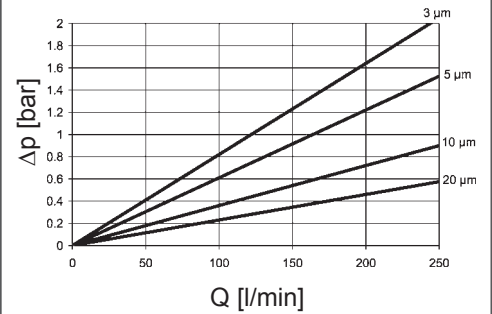

#### BN4HC: 330

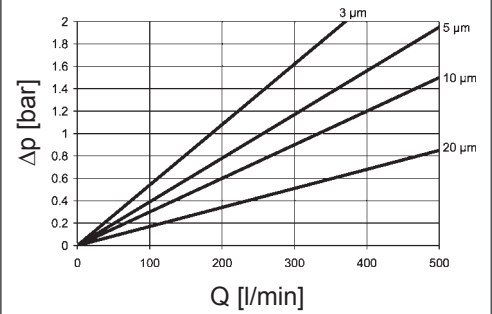

#### BN4HC: 660

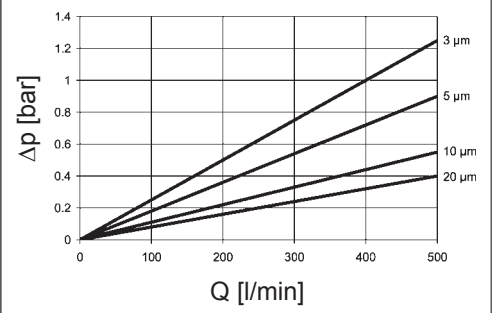

## 4. DIMENSIONS

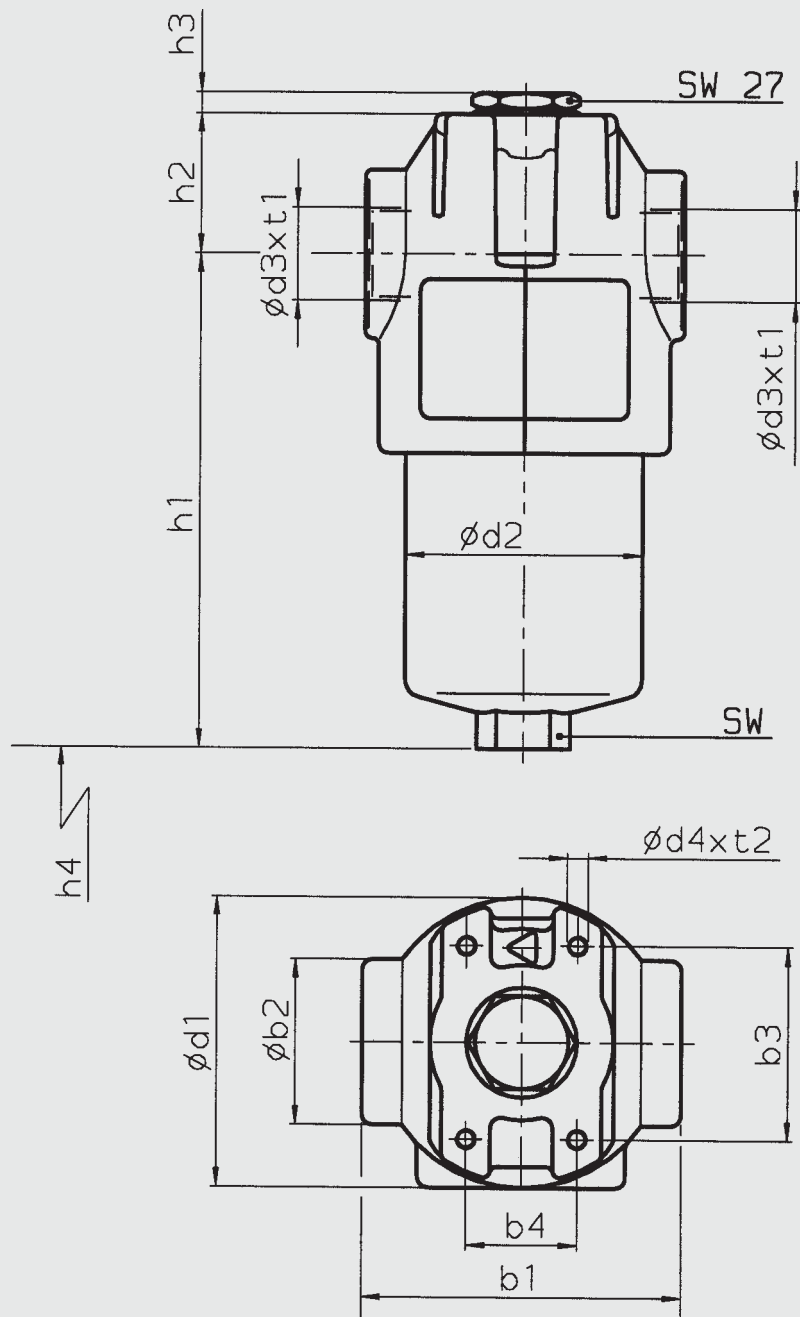

LF / LFF	b1	b2	b3	b4	d1	d2	d3	d4	h1	h2	h3	h4	SW	t1	t2	Weight including element [kg]	Volume of pressure chamber [l]
30	69	36	45	30	67	52	G $\frac{1}{2}$	M5	125.5	31	7	75	24	15	8	0.8	0.13
60	90	48	56	32	84	68	G $\frac{3}{4}$	M6	137.5	39	6	75	27	17	9	1.5	0.24
110	90	48	56	32	84	68	G $\frac{3}{4}$	M6	207.0	39	6	75	27	17	9	1.8	0.42
160	125	65	85	35	116	95	G $1\frac{1}{4}$	M10	190.5	46	6	95	32	21	14	3.7	0.60
240	125	65	85	35	116	95	G $1\frac{1}{4}$	M10	250.5	46	6	95	32	21	14	4.3	0.80
330	159	85	115	60	160	130	G $1\frac{1}{2}$	M12	252.5	50	6	105	36	23	17	8.0	1.50
660	159	85	115	60	160	127	G $1\frac{1}{2}$	M12	417.5	50	6	105	36	23	17	11.0	3.00

### NOTE

The information in this brochure relates to the operating conditions and applications described.  
For applications or operating conditions not described, please contact the relevant technical department.  
Subject to technical modifications.

**HYDAC FILTERTECHNIK GMBH**  
Industriegebiet  
**D-66280 Sulzbach/Saar, Germany**  
Tel.: 0 68 97 / 509-01  
Fax: 0 68 97 / 509-300  
Internet: [www.hydac.com](http://www.hydac.com)  
E-mail: [filter@hydac.com](mailto:filter@hydac.com)